

[3]

*n*-PbTe

*d*.

Pb e

*p*-Pb e *d* = 10-200  
*p*-Pb e,

Al<sub>2</sub>O<sub>3</sub>.

*d*

IV VI

: 1.

PbTe, PbSe PbS. – .: , 1968. 2.

*Dresselhaus M.S., Dresselhaus G., Zhang Z. et.al.* Low-dimensional thermoelectric materials // *Physics of the solid state.* – 1999. – V. 41 ( 5). – P. 679-682. 3. *Rogacheva E.I., Tavrina T.V., Nashchekina O.N., Grigorov S.N, Nasedkin K.A., Dresselhaus M.S., Cronin S. B.* Quantum size effects in PbSe quantum wells// *Applied Physics Letters.* V.80, N 15, 2690-2693, 2002.

621.039.624

-1 [1]

[2],

[3].

5 ,  
 - 0-250 ,  
 - 0-238 (18944,8 / ).  
 . 2  
 0,2

. 1, 1 - , 2 -  
 ( ), 4 -  
 , 6 -  
 3,5  
 -  $5 \cdot 10^{-5}$  -  $1 \cdot 10^{-3}$

4,5

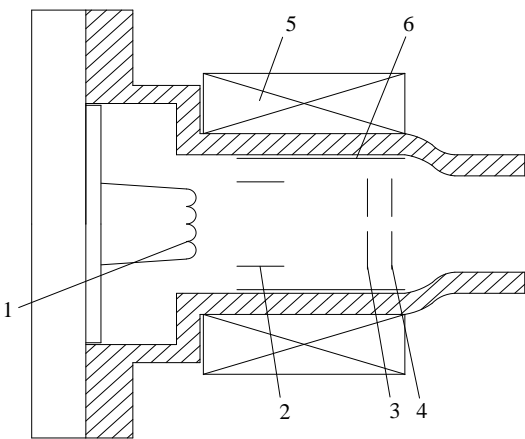

. 1.

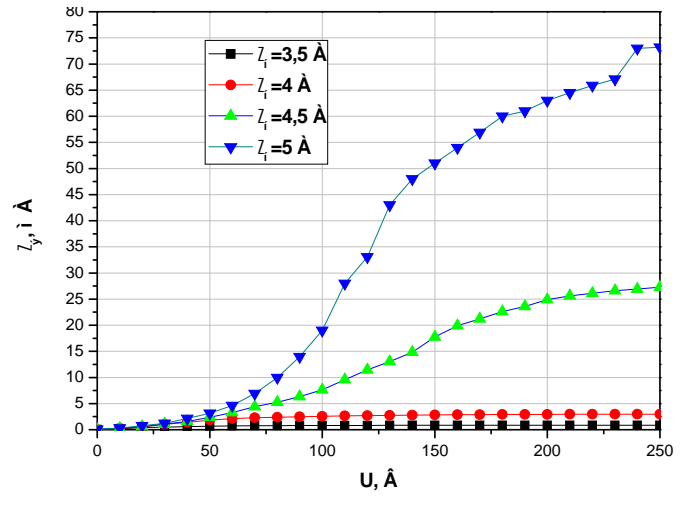

. 2.

. 3.

. 4

$7 \cdot 10^{-5}$

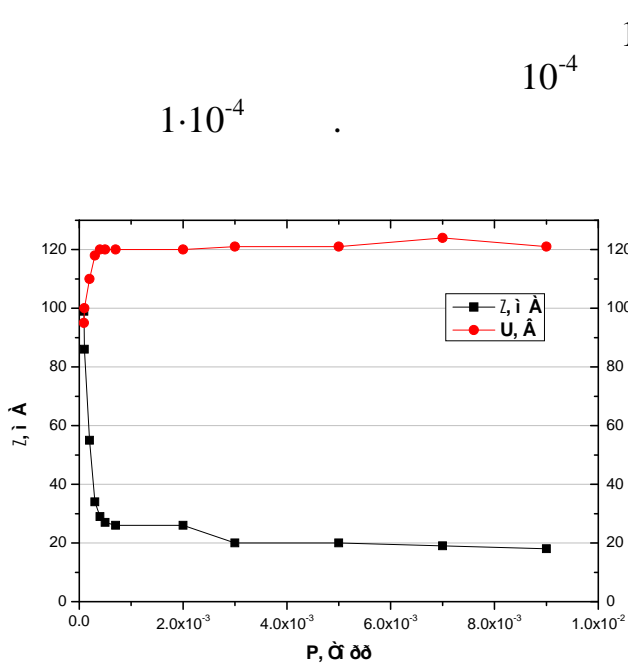

. 3.

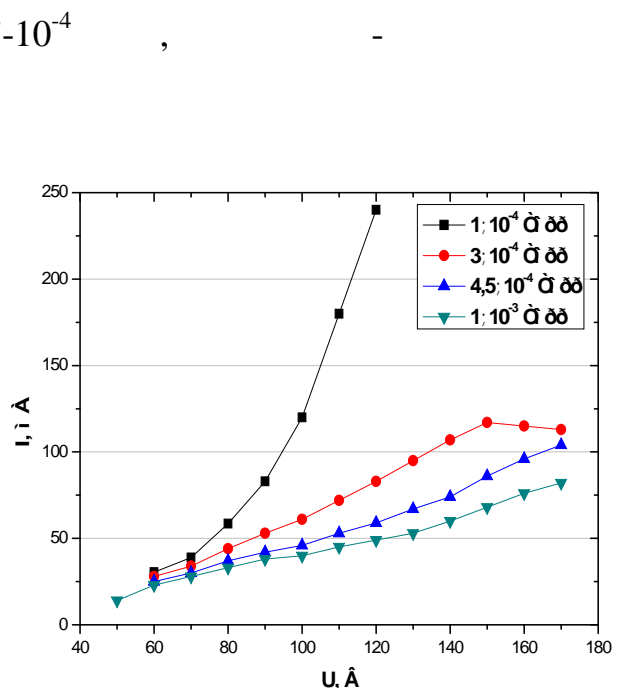

. 4.

50-120 .

120

50

80-120 ,

: 1. Yegorov A.M., Yuferov V.B., Shariy S.V., Seroshtanov V.A., Druy O.S. «Preliminary study of the demo plasma separator» 1(59) 2009 . : « » . 122-124. 2. : , . 2 . .1/ . . . . - : - , 2005. - 600 . 3. . . . " , 1972. - 224 .

620.25

\_\_\_\_\_ . ;

. ; . . - .

**Pd – Au**

Pd-Au

10 ÷ 30 ,